

# AVAILABLE FOR SUBLEASE



## Flour Mill Office Building 1000 Potomac Street, NW, Washington, DC

### Information:

**Suites:** 150  
**Size:** 4,049 sq. ft. (will subdivide)  
**Rental:** \$40.00 Full Service  
**Available:** Immediately  
**Term:** Thru May 31, 2014

### Features:

- Plug & Play office space
- 1st floor suite with exterior entrances
- Property is walking distance to Georgetown's restaurants, shops and hotels.

**For More Information Please Contact:** Sharon M. Oliver  
Philip E. Meany  
Martin P. Griffin  
703-516-7050

**MEANY & OLIVER**  
Real Estate Brokerage, Consulting & Investment

The information above has been obtained from sources believed reliable, Meany & Oliver Companies makes no guarantees, warranties, or representations as to the completeness or accuracy thereof. The presentation of this property is submitted subject to errors, omissions, changes to price or conditions prior to sale or lease, or withdrawal without notice.

# Flour Mill Office Building

## 1000 Potomac Street, NW, Washington, DC

---

**Suite 150**  
**Size: 4,049**  
**rentable sq. ft.**

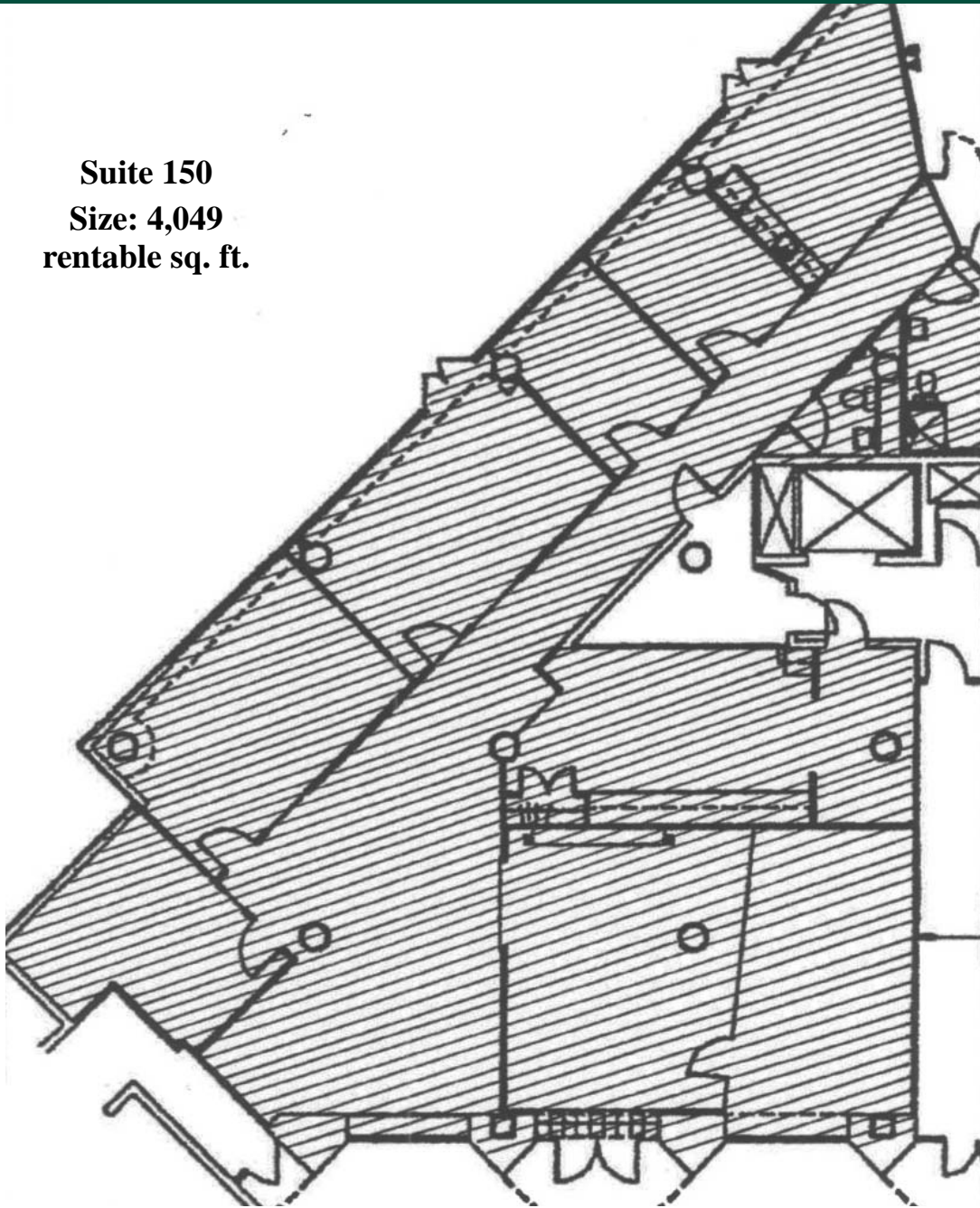

---

**For More  
Information  
Please Contact:**

Sharon M. Oliver  
Philip E. Meany  
Martin P. Griffin  
703-516-7050

**MEANY & OLIVER**  
Real Estate Brokerage, Consulting & Investment

The information above has been obtained from sources believed reliable, Meany & Oliver Companies makes no guarantees, warranties, or representations as to the completeness or accuracy thereof. The presentation of this property is submitted subject to errors, omissions, changes to price or conditions prior to sale or lease, or withdrawal without notice.